

## 12 HDX Equipment Specifications

Length: 53' Height: 13'3" Width: 8'6" with ability to expand to: 13'6"

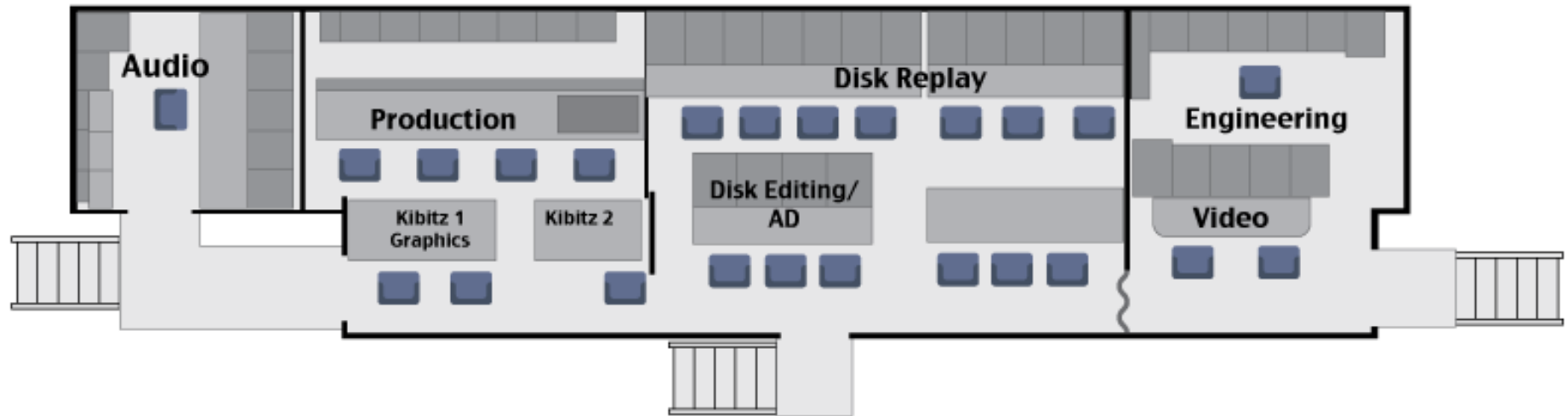

# 12 HDX Equipment Specifications

## Production

- Grass Valley HD Kalypso switcher with doubletake feature
- 4 M/Es, 75 inputs/48 outputs
- Internal Image Store and DVEs
- Up to 84 images in production wall
  - [Click here for monitor wall](#)

## Cameras/ Lenses & Support

- 8 Grass Valley LDK 8000 Elite 720p/1080i triax cameras
- 6 Canon 72x9.3 long lenses
- 2 Canon XA17x7.6 ENG lenses
- Canon HJ11x4.7 ENG wide angle lens
- 6 Grass Valley SuperExpander sleds long lens adapters
- 6 Vinten Vector 70 heavy duty pan/tilt heads
- 6 Mathews MT1 heavy duty tripods
- 3 Gitzo ENG tripods with Libec H85 pan/tilt heads
- 2 Studio Config Kits with LCD VF
- 2 SD LPS clock cameras

## Replay, Spotbox and Edit Systems

- Two 6 channel HD XT2 full editing units 4 inputs/ 2 outputs
- Two 4 channel HD XT2 full editing units 2 inputs/ 2 outputs
- 4 Channel EVS XS server for Spotbox
- XFile3 with USB 3.0
- GigE network available
- 3 VHS/DVD player/recorders
- Up to 6 replay operator positions

## Audio

- Euphonix System 5B Audio Mixer (48 faders)
- 96 Inputs/ 96 outputs
- Audio Board can output multiple channels of surround sound
  - *Encoders for transmitting surround sound are the clients responsibility*
- Enco Hotshot2 Audio Payout System
- Digicart II Plus with ZIP drive
- CD Player
- 5 Audio Technica AT 4071A long shotgun mics
- 8 Sennheiser 416 P48 short shotgun mics
- 6 Sennheiser MD-46 stick mics
- 6 RE 50 stick mics
- 5 EV 635 stick mics
- 10 Sony ECM77B lavalier mics
- 7 Sennheiser HMD sportscaster headsets
- 6 Daltech talkback boxes
- 6 DT12 Breakout Boxes
- 14 DT12 fanout
- 6 Fostex portable speakers
- Videotek ASM-100 audio scope
- Fiber Booth Kit (Upon request)

## Communications

- RTS 64-port Cronus System
- 12 Channels of IFB
- 12 Channels of PL
- 17 RTS BP325 headset beltacks
- 11 RTS 4030 IFB beltacks
- 2 RTS DKP-8 stations
- 4 Telos One Interfaces
- 3 RTS TIF 2000As
- 12 Line NEC phone system
- 6 Two-Way Radios with 2 base stations

## Graphics

- Chyron HyperX3
- Fox Box (provided for Fox shows only)
- Chyron HD Codistrator with LCD touchscreen

## Engineering & Misc

- 128x256 PESA HD-SDI Router
- 19 Frame sync/cross converters
  - 6 Harris X-75s, 1 Harris X-50, 12 AJA FS-1s for a total of 19 paths
- 2 Lighting Kits

## Outboard Monitors

- Ten 16" Outboard flatscreen LCD video monitors
- Two 9" portable color monitors
  - *Capability to provide HD program to booth (If fiber is available)*

## Cable

- 5600' Triax
  - Six 500', Five 250', Ten 100'
  - Two 5 line triax mults 175'
- 500' 10 Line video mult
  - Two 150', Four 50'
- 300' TAC singlemode fiber
  - Two 150' TAC-12
- 2000' DT12
  - Five 250', Five 150'
- 125' Three phase power cable
  - Sets of 75' and 50'
- Additional cable available if shipped separately

## Power Required

- 208 VAC, three phase, 200 amps
  - *Separate 200 amps of three phase 208 VAC may be required in high heat locations*